

## Two Circuit Plus Battery Switch

Two Circuit Plus 300A DC

### Caution

- ▶ Disconnect positive battery terminal before installing.
- ▶ Consult marine electrical professional for proper wiring application.

### Installation

- ▶ Refer to the latest edition of NFPA 302 and/or ABYC E11 Standard for installation information.
- ▶ Attach one 4/0 AWG cable per terminal to meet ratings.
- ▶ Battery cable terminals must be attached under nut and lock washer. Torque 120 in-lb (13.56 N•m).

### Operation

- ▶ Turn all appliances off before turning the battery switch to OFF.
- ▶ Do not switch to OFF while engine is running.

### Dimension

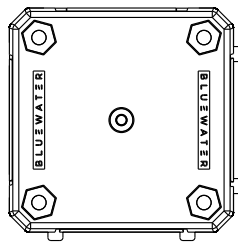
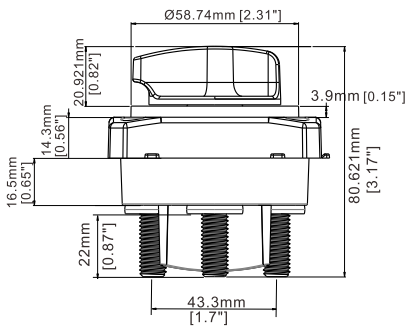
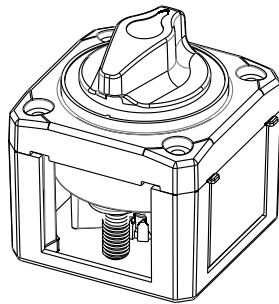
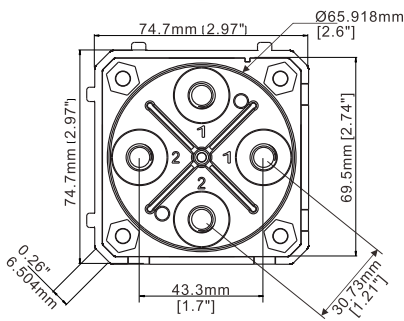

### Parts # 9800-011-X

- ▶ Color: 9800-011-0 (Black), 9800-011-1 (Red)

Continuous Rating	300 Amps DC
Intermittent Rating	500 Amps DC 5 min.
Cranking Rating	900 Amps DC 30 sec.
Maximum Voltage	48 Volts DC
Switch Operating	-22°F to 284°F
Mounting	Surface / Front , Rear Panel
Cable Size	4/0 AWG (120 mm <sup>2</sup> )
Standard	meet S.A.E. J1625, J1171, ABYC E-11 UL1500 (Ignition protection)
Stud size	2pcs 3/8"-16
Torque rating	120in-lb (13.56Nm) max.
Studs and Nuts	Copper with Tin plated

### Wiring

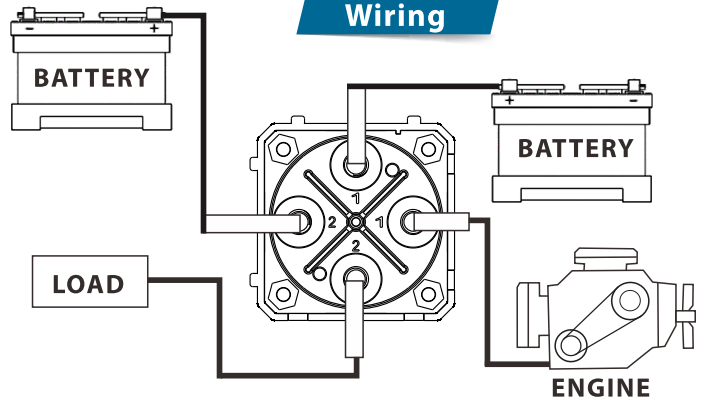

### Mounting Holes

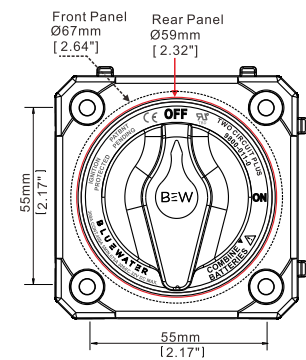

### Mounting

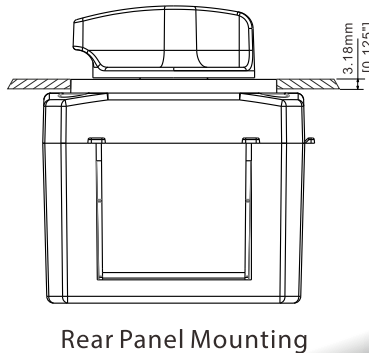
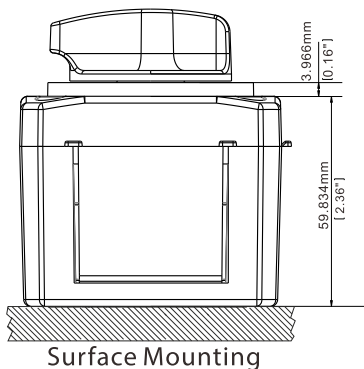

Rear Panel Mounting

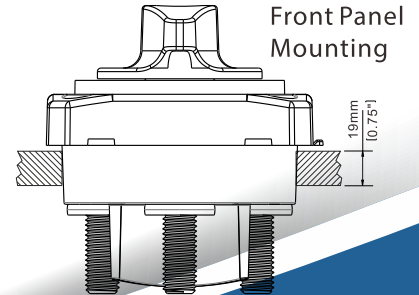

Front Panel Mounting